



**STARTING AT**  
**\$704,500**

2,153 Sq. Ft.

2 Story

4 Bed

3 Bath

2 Car Garage

Cattle Ridge Residence 2 invites you to embrace 2,153 square feet of elevated living, where elegance and comfort seamlessly come together. This two-story stunner features 4 bedrooms, 3 full bathrooms, and a flexible loft, all designed to create a perfect blend of style and practicality. The first-floor bedroom and full bath offer a welcoming haven for guests or an ideal space for multi-generational living.

The heart of the home is designed for entertainment, with a seamless layout connecting the kitchen, dining, and living areas, perfectly suited for any occasion. Take the experience outdoors with an optional covered patio, turning your backyard into a dreamy alfresco retreat for sunrise coffees, afternoon lounging, or star-filled evenings under the open sky.

Upstairs, the airy loft offers boundless possibilities whether it becomes a media room, play zone, or an inspiring home office is entirely up to you. The primary suite is nothing short of a sanctuary, complete with a luxurious ensuite bath and a spacious walk-in closet that ensures your private retreat is as indulgent as it is serene.

With a 2-car garage providing generous storage and convenience, Residence 2 delivers a lifestyle where refined living meets functional design in the vibrant, master-planned community of Summer Lake North. It's not just a home, it's where memories are made, dreams are realized, and every moment feels extraordinary.

**Please consult with sales agent for complete details.**



**Residence 2 | Farmhouse**



**Residence 2 | Spanish**



**Residence 2 | Tuscan**



First Floor

**PRELIMINARY**



SECOND FLOOR

DENOVA HOMES  
SUMMERLAKE VILLAGE 1  
PLAN 2 SPANISH

Second Floor



ELEVATION TUSCAN  
SECOND FLOOR  
(SAME AS SPANISH)

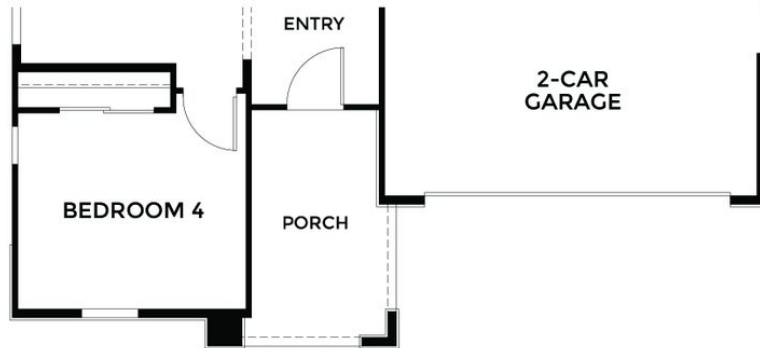

ELEVATION TUSCAN  
FIRST FLOOR

ELEVATIONS

DENOVA HOMES  
SUMMERLAKE VILLAGE 1  
PLAN 2 SPANISH

Elevation Tuscan



ELEVATION FARMHOUSE  
SECOND FLOOR  
(SAME AS SPANISH)

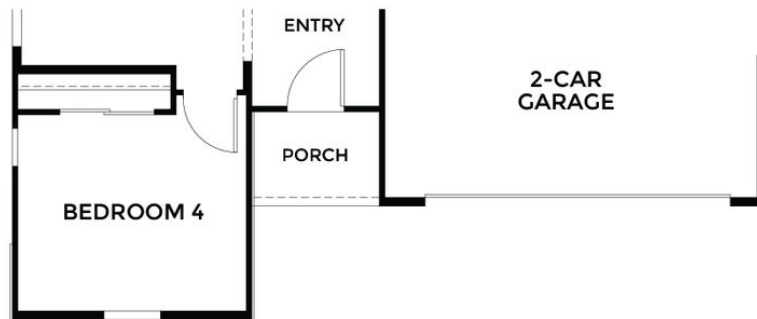

ELEVATION FARMHOUSE  
FIRST FLOOR

ELEVATIONS

DENOVA HOMES  
SUMMERLAKE VILLAGE 1  
PLAN 2 SPANISH

Elevation Farmhouse

PRELIMINARY

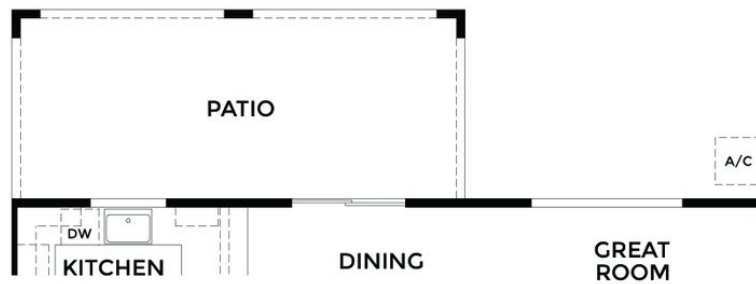

OPTIONAL  
PATIO

OPTIONS

DENOVA HOMES  
SUMMERLAKE VILLAGE 1  
PLAN 2 SPANISH

Optional Patio